



GRANROOF

-CARPORT CANOPY-

**APR
2025**

PT YKK AP INDONESIA
ENGLISH VERSION

TABLE OF CONTENT

01. ABOUT GRANROOF

Concept & Product Feature	1
Product Features	3
Product Specification	4
Color Variation	5
General Carport Condition Survey	6
Precautions	7

02. SYSTEM DRAWING, PRICE, MAINTENANCE

Wall Mounted - Square	8
Free Standing - Square	14
Price List	19
Optional Parts	20
Maintenance Information	26

WHAT IS GRANROOF

Long Life Design With Modern Shapes and High-Performance Materials

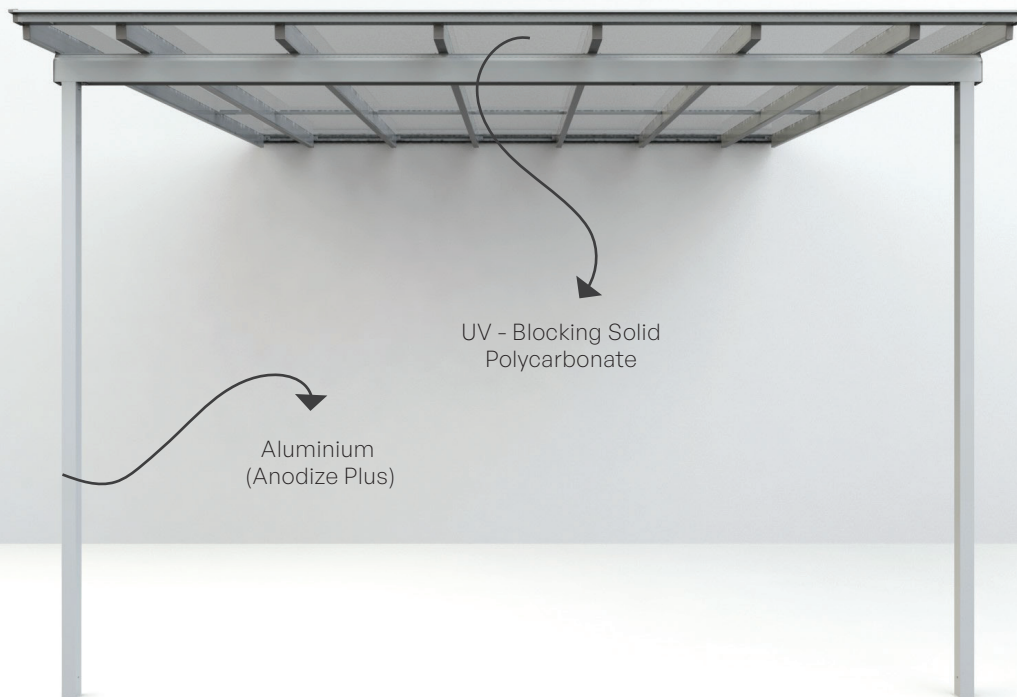

1 Aluminium Structure

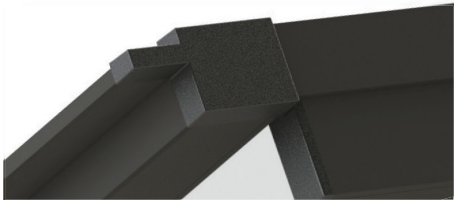

YKK AP Aluminium finishing color use **ANODIZE PLUS** trusted for exterior uses

2 Roof panel

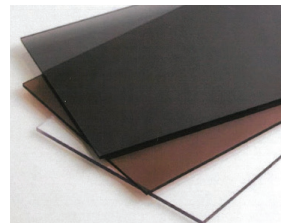

UV-blocking solid polycarbonate by PT SBP Indonesia(Sumitomo Bakelite) with Japan quality, creating a bright space.

3 Adjustable Structure



Roof angle is adjustable between 3~7° thanks to the adjustable yet stable structure.

4 Easy and Clean Installation

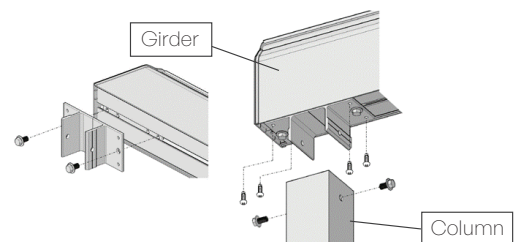

Designed & creafed for easy on-site assembling doesn't need welding. No need to worry about rusting

PRODUCT FEATURES

Functionality

High functionality to protect your car & family

• Non Rusting

Anodized aluminum finish that can be used for a long time without rusting

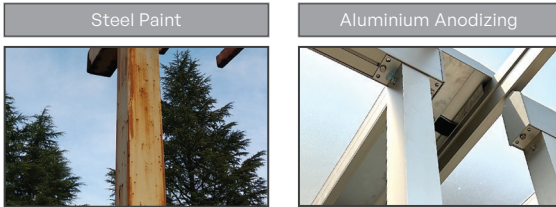

• Certain Quality (Processed by API)

Processed by manufacturer, and delivery with knock down style to maintain the quality.

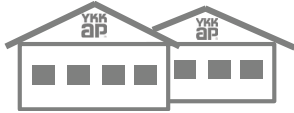

• High Durability

Design Load: Up to wind speed equivalent to **32.1 m/s**, tested & passed



*Design load above: No consideration for seismic force

*With wind speed 20 m/s, human cannot keep standing

Load Capacity Test: For load capacity reaches **31.8kg/m²**

*But **"don't climb on top of carport"**

There is a risk of roof material being damaged or falling.



Quality & Performance

Higher performance and durability ever

• UV - Blocking

UV-blocking solid polycarbonate roof that protects your car from the sun.

	Clear	Bronze	Gray
Color image			
Light Transmission	85%	27%	28%
UV Transmission	Almost 0%	Almost 0%	Almost 0%

* Polycarbonate by **PT. SBP Indonesia** A Group Company of Sumitomo Bakelite Co., Ltd JAPAN **SUNLOID** Solid Flat Sheet

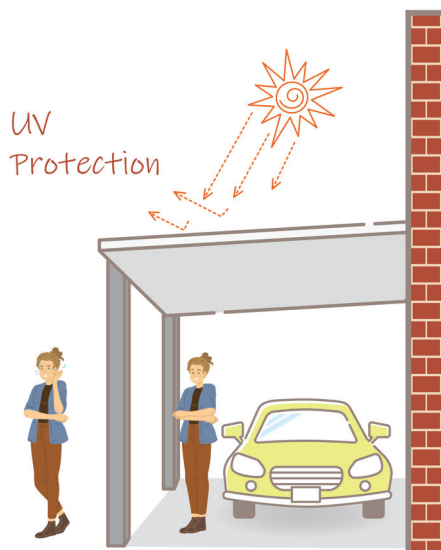

• Stylish Drainage Roof Fin

The roof shape also serves as a drain to prevent rain drips and water splash from making stains on cars or objects.

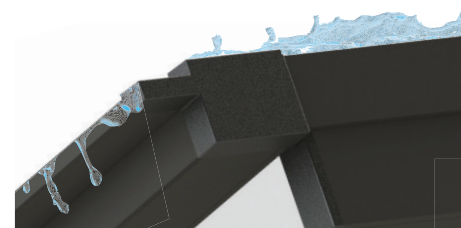
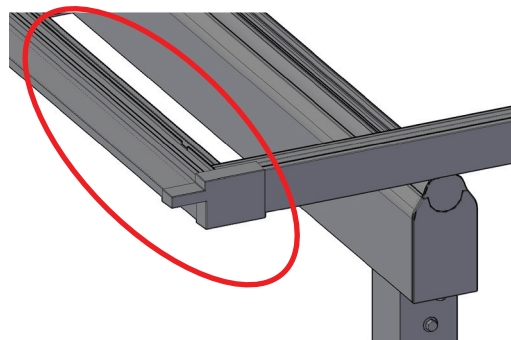

Do you know?!
This is the advantage
of our products



PRODUCT SPECIFICATION

Maximum size :WR6000×DR5500

H=3000, H=3500 (Wall Mounted)

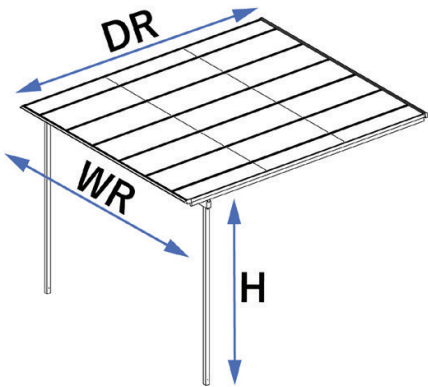
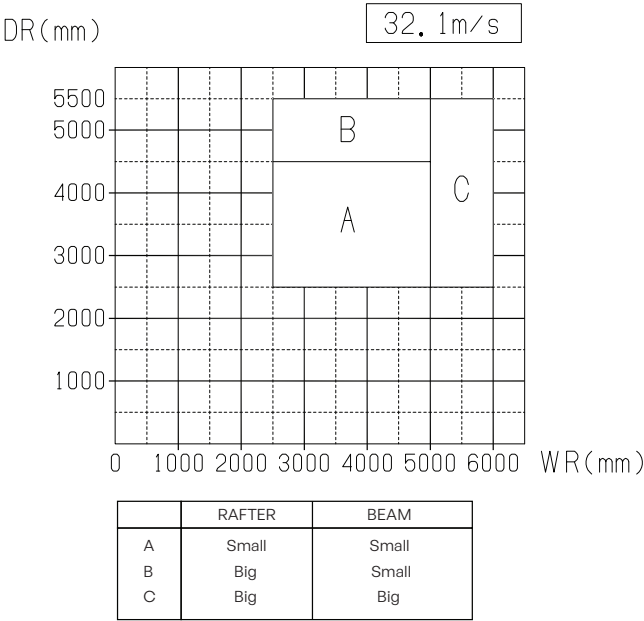

Specification

Keep your options open, because we have wide variations to choose

Product Line Up

Wall Mounted

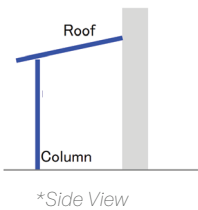

*Side View

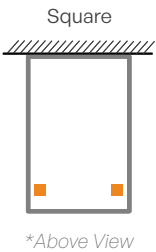

*Above View

Free Standing

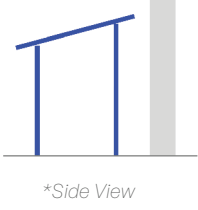

*Side View

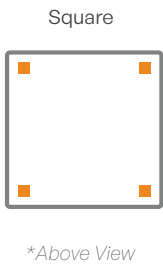

*Above View

Optional Parts

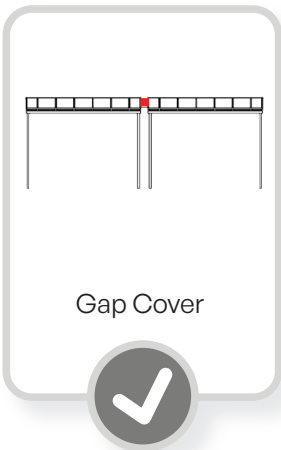

Gap Cover

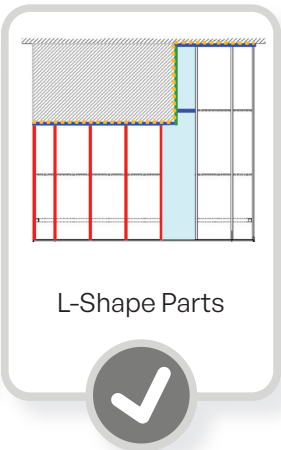

L-Shape Parts

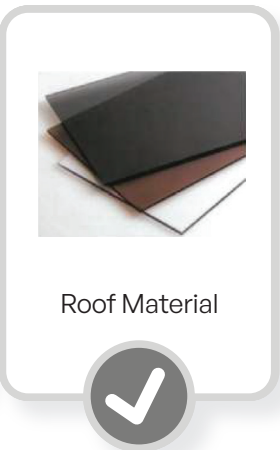

Roof Material

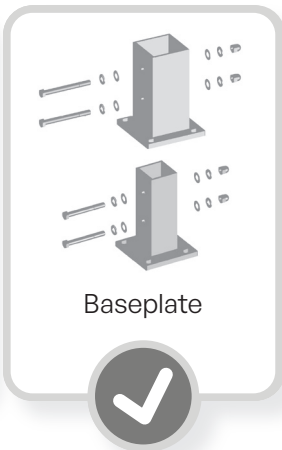

Baseplate



COLOR VARIATIONS

Aluminium Structure : 4 Options

ANODIZED PLUS is another innovation from **YKK AP**. Anodizing with Electro Deposition process create two types of appearance, glossy and non glossy which provides an extra layer of protection on the anodized layer. Its anodized coating combined with an organic protective coating offers the dual benefit of increased resistance to stain and color degradation.

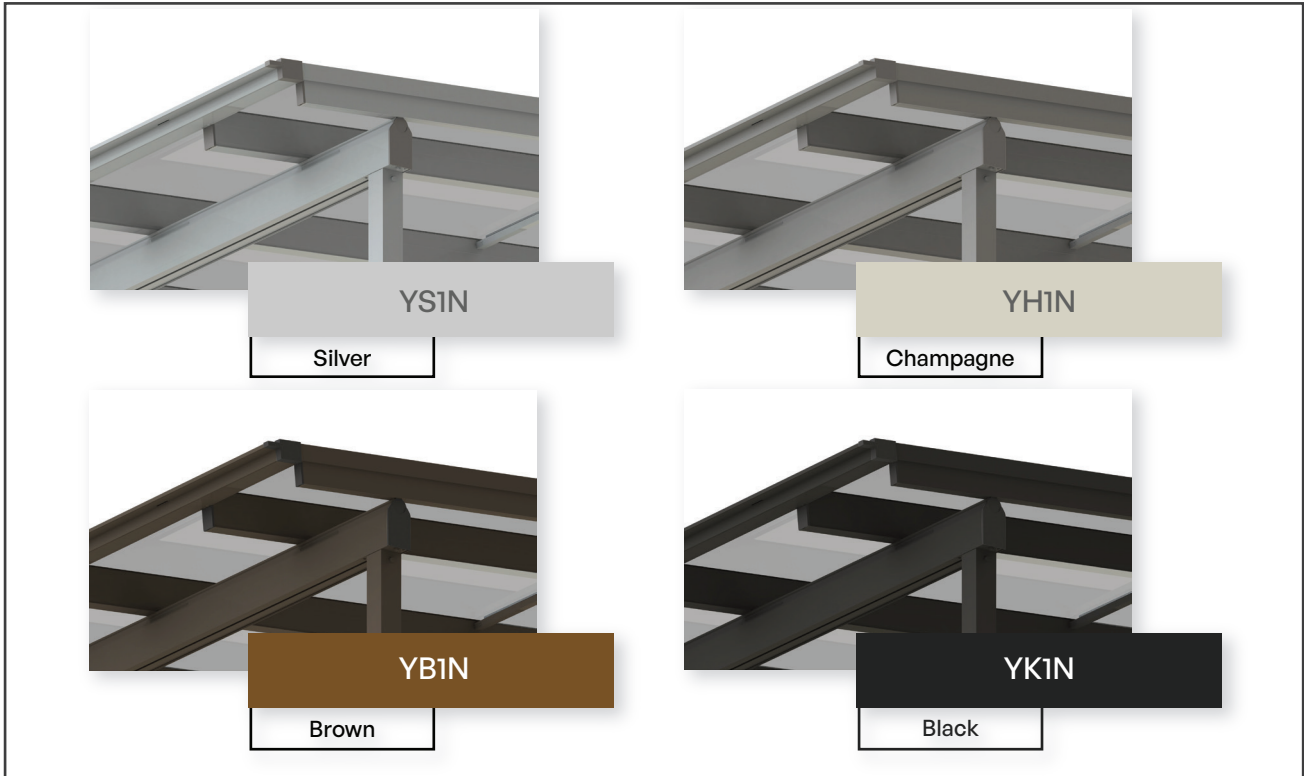

Roof Polycarbonate : 3 Options

UV - blocking solid polycarbonate by PT SBP Indonesia (Sumitomo Bakelite) with Japan quality, creating a bright space.

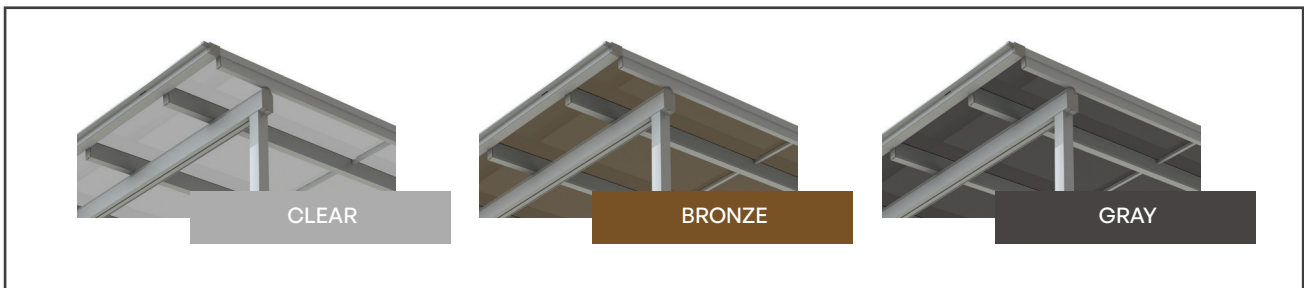

*Illustration Image

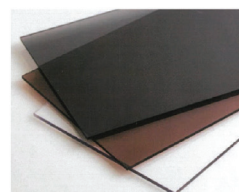

PRECAUTIONS

• About the Price List

- The prices listed in this catalog include polycarbonate, installation fees, and assembly fees
- The price list is listed in units of WR, and less than DR should be rounded up
- Ex) WR 4650 x DR 3800 = The price will be 5000 x 4000

• Delivery Destination

Only DIS warehouse or workshop, on-site delivery is not possible (Can be picked up at the factory upon request)

• Quality Assurance

2 years for the product GRANROOF

10 years for aluminium surface treatment of profile, 2 years for parts

*Please check below for disclaimers

YKK AP Indonesia's official distributors guarantees for the quality of assembly, installation, and sealing request)

• Disclaimer

Even within the warranty period, repairs will be charged in the following cases :

- Problems when installed in a place that requires performance that exceeds the performance of this product
- Defects caused by processing, assembly, construction (foundation work, installation work, sealing work, etc.), management, maintenance, etc. by a third party that is not arranged by our company (Example: Corrosion due to using sea sand or mortar using accelerator materials. Corrosion due to the use of cleaning agents other than neutral detergents. Discoloration and corrosion due to poor curing during construction, etc.)
- Product defects caused by defects other than the product, such as deformation of the building frame
- Defects such as changes in products or parts over time (wear and tear due to use, etc.) or deterioration over time (changes in quality of resin parts, discoloration, etc.)
- Corrosion or other defects caused by the natural environment or living environment around the product (for example, corrosion caused by salt damage, dust in the atmosphere, soot, various metal powders, sulfurous acid gas, ammonia, corrosion caused by car exhaust gas, abnormal high temperature, low temperature, high humidity etc)
- Problems caused by natural disasters or other force majeure (for example, windbreaks, heavy rains, storm surges, earthquakes, lightning strikes, floods, land subsidence, fires, tsunamis, eruptions, etc)
- Problems caused by small animals such as dogs, cats, birds, and mice
- Problems caused by operational errors after delivery, improper adjustment, or improper maintenance
- Problems caused by customer's own assembly, processing, installation, repair, modification
- Defects caused by use for purposes other than the intended purpose, or defects caused by use in a manner different from the intended use.
- Damage or malfunction caused by illegal acts such as crime

* Fee will be charged for replacement after the warranty period has expired

* This document does not limit customer's legal rights. If customers have any questions about repairs after the warranty period has expired, please contact our sales office

WALL MOUNTED

SQUARE



WALL MOUNTED (TYPE A)

SQUARE

SYSTEM DRAWING

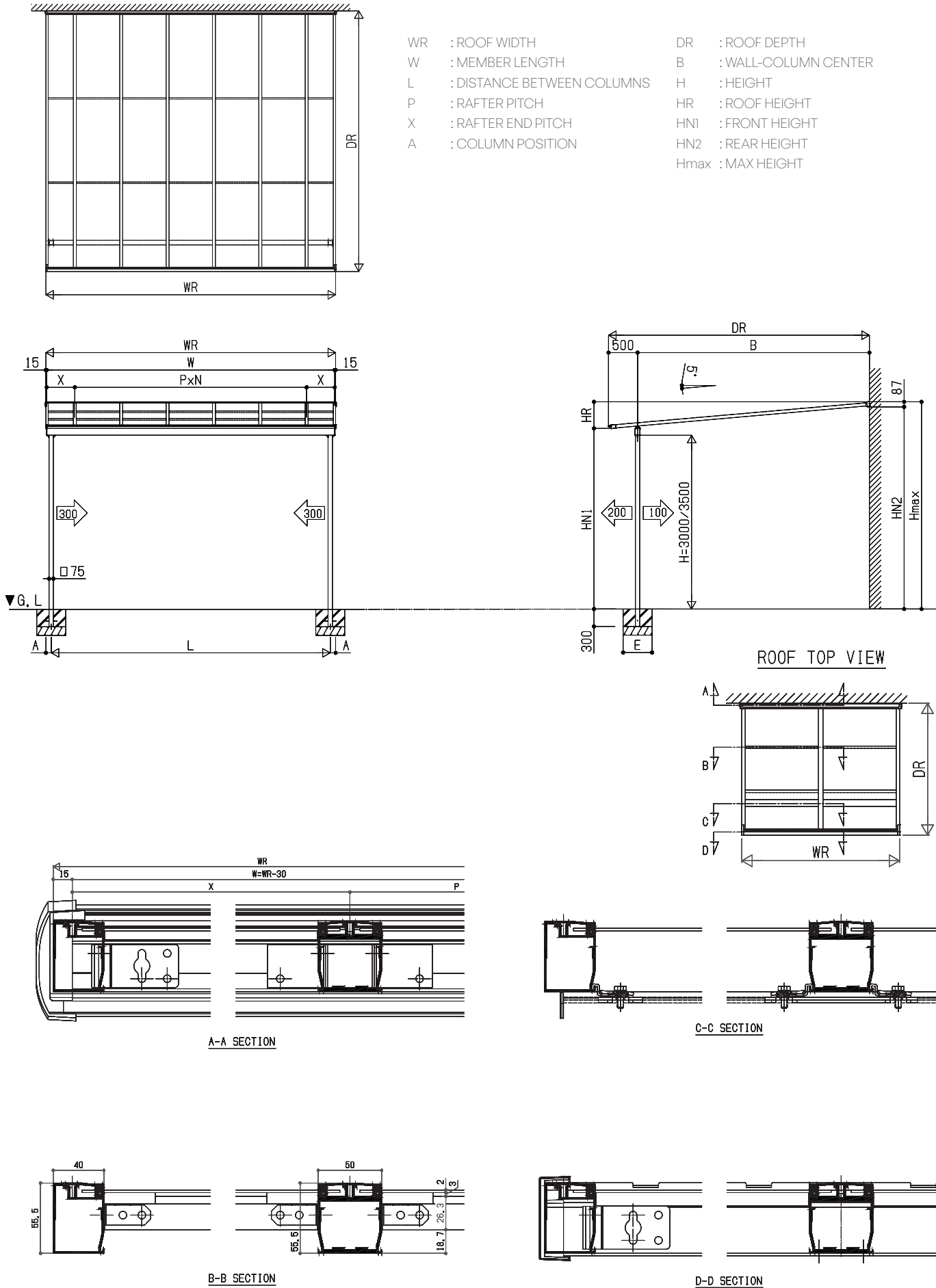

WALL MOUNTED (TYPE B & C)

SQUARE

SYSTEM DRAWING

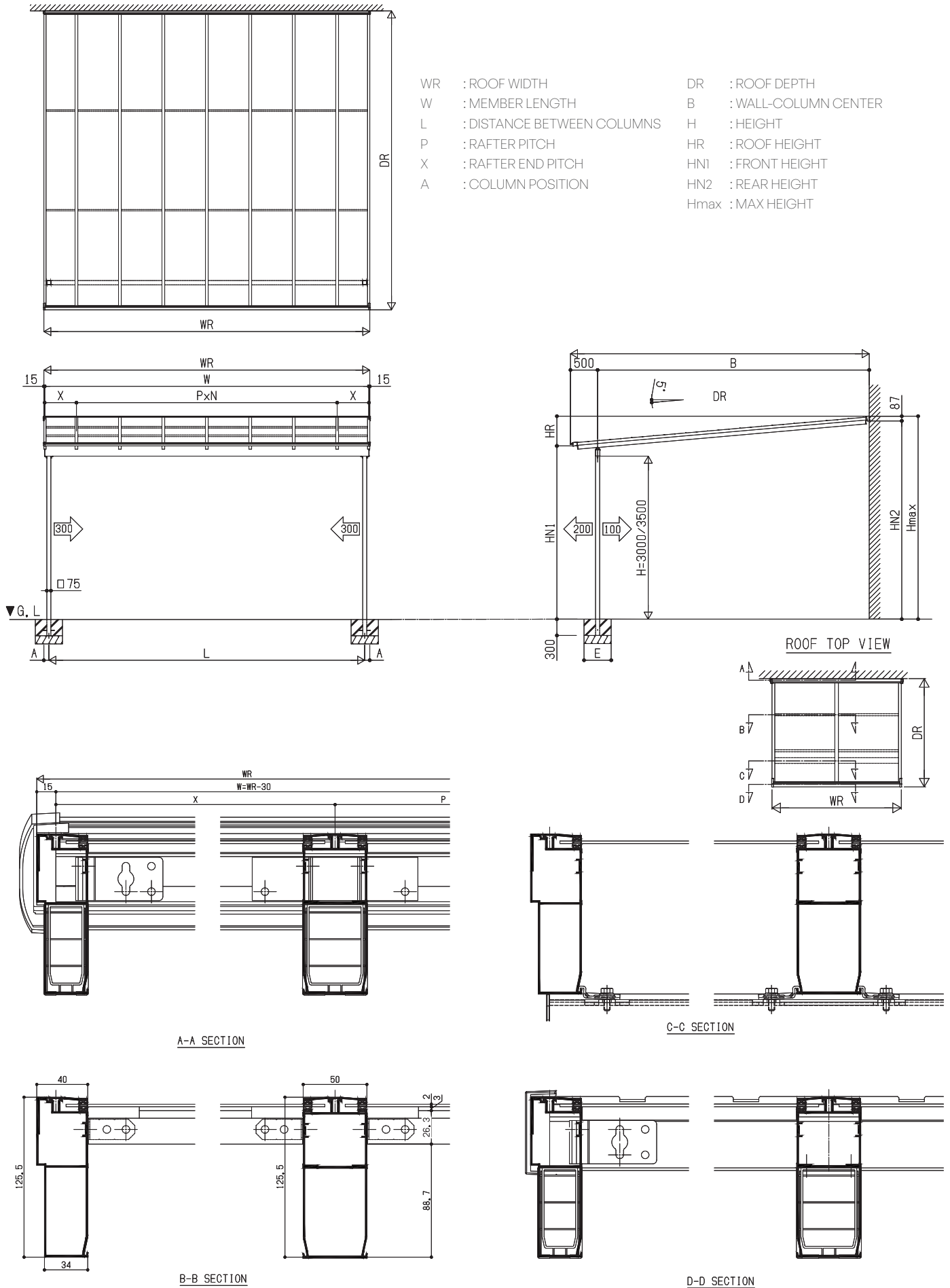

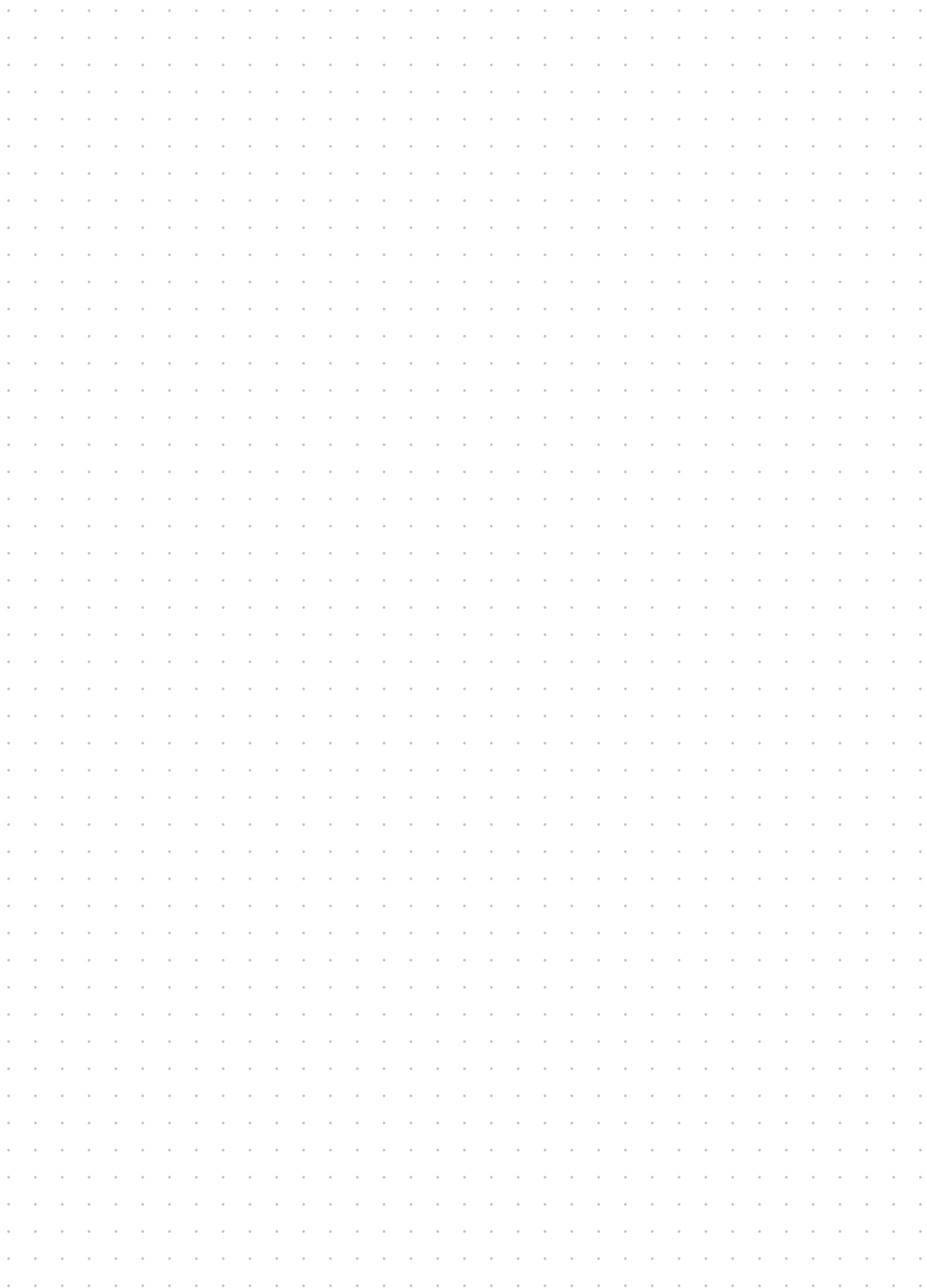

FREE STANDING

SQUARE



FREE STANDING (TYPE A)

SQUARE

SYSTEM DRAWING

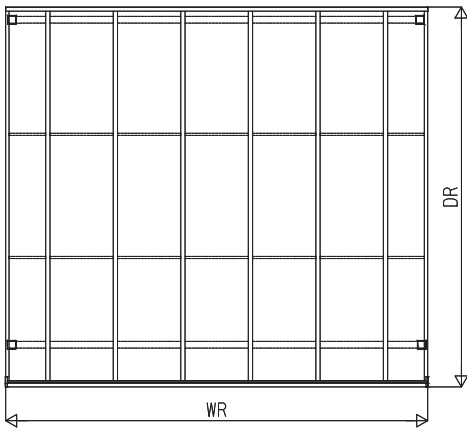

WR : ROOF WIDTH
W : MEMBER LENGTH
L : DISTANCE BETWEEN COLUMNS
P : RAFTER PITCH
X : RAFTER END PITCH
A : COLUMN POSITION

DR : ROOF DEPTH
B : WALL-COLUMN CENTER
H : HEIGHT
HR : ROOF HEIGHT
HN1 : FRONT HEIGHT
HN2 : REAR HEIGHT
Hmax : MAX HEIGHT

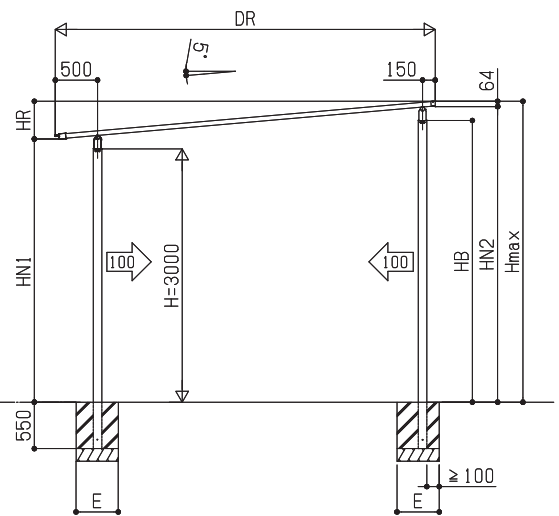
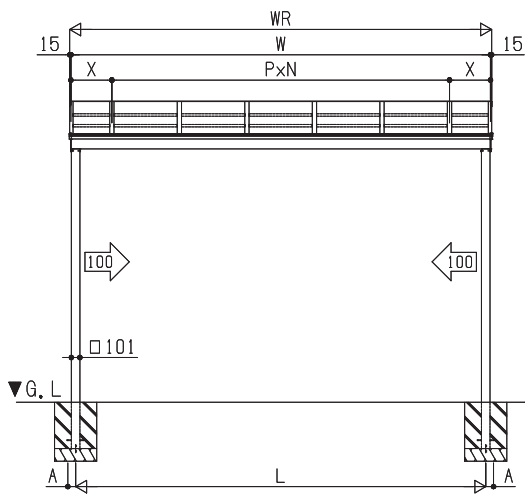

ROOF TOP VIEW

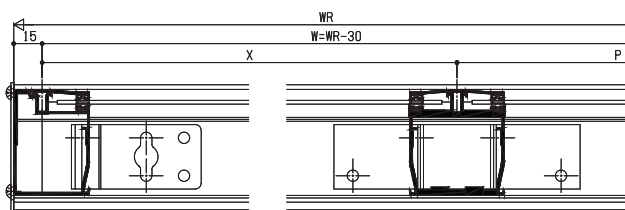
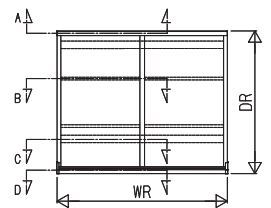

A-A SECTION

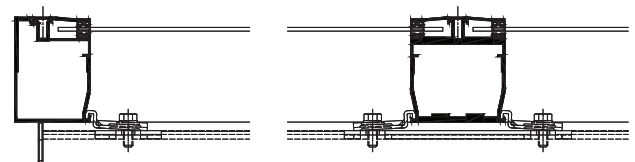

C-C SECTION

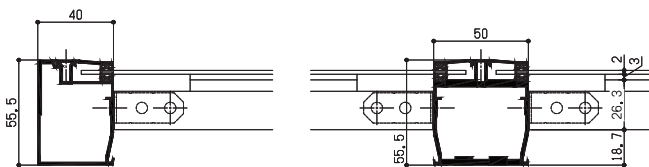

B-B SECTION

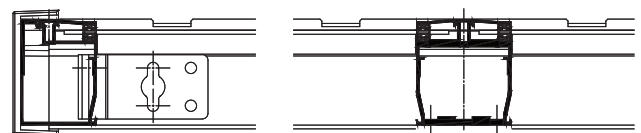

D-D SECTION

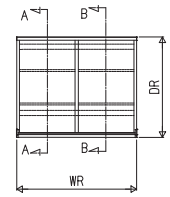

ROOF TOP VIEW

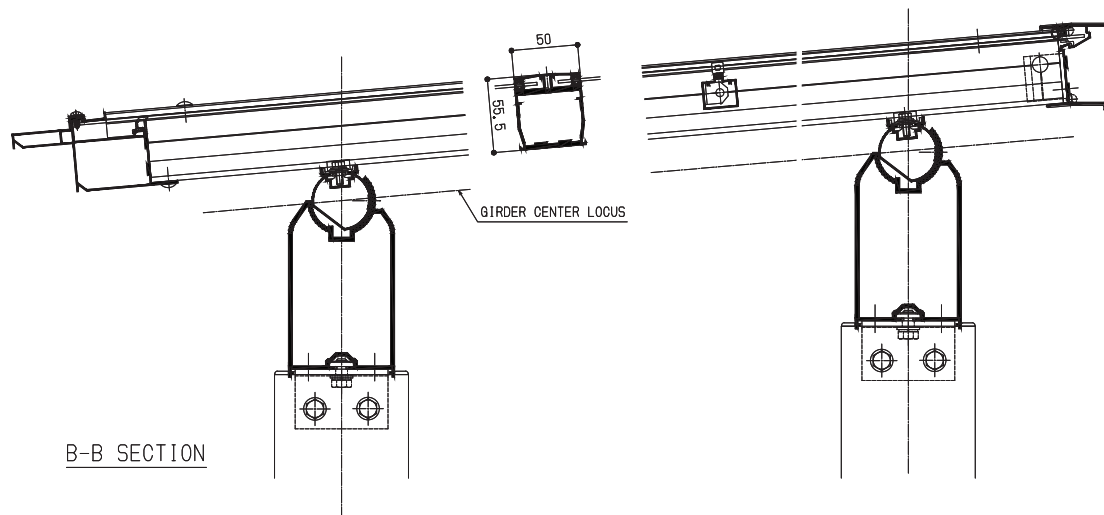
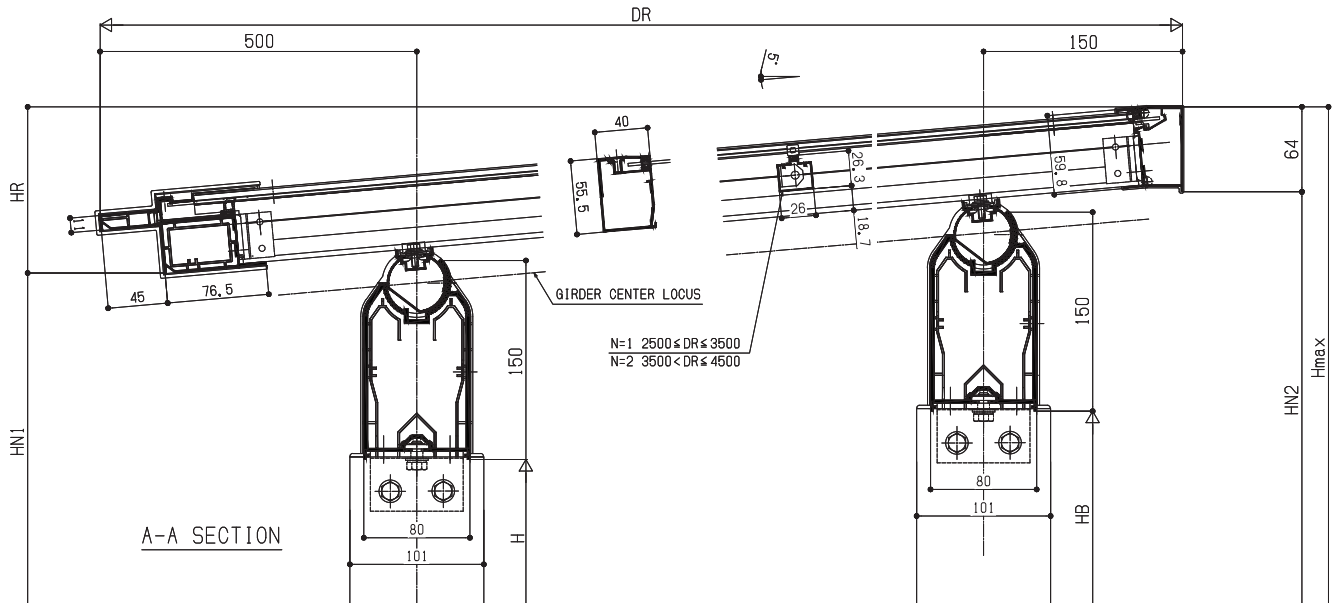

SYSTEM DRAWING

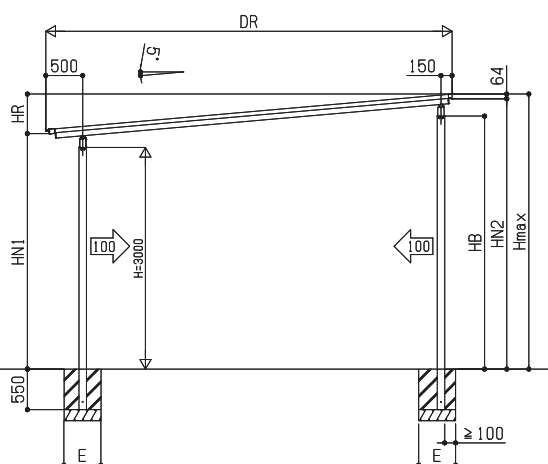

ROOF TOP VIEW

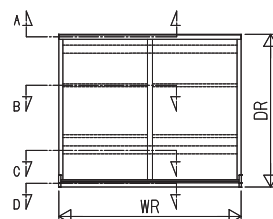

FREE STANDING (TYPE B & C)

SQUARE

SYSTEM DRAWING

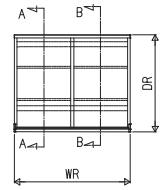

ROOF TOP VIEW

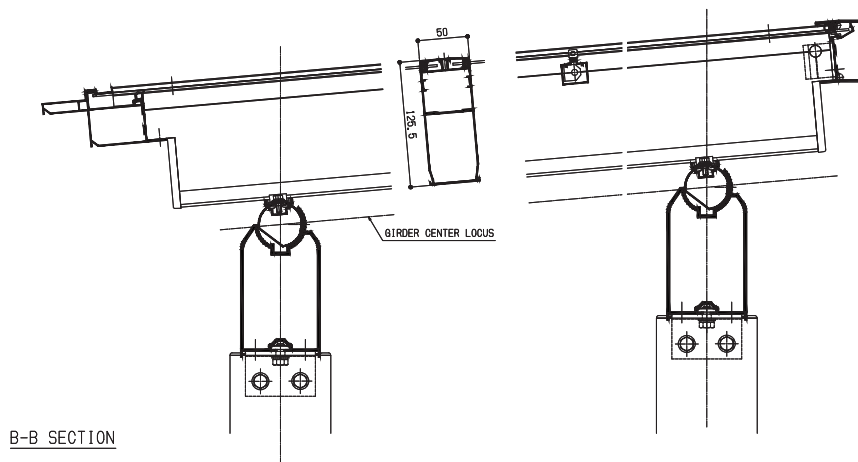
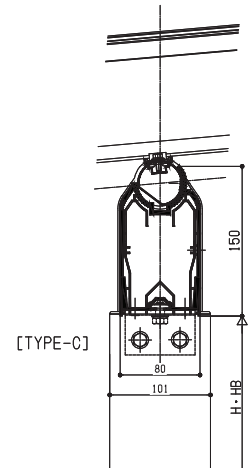
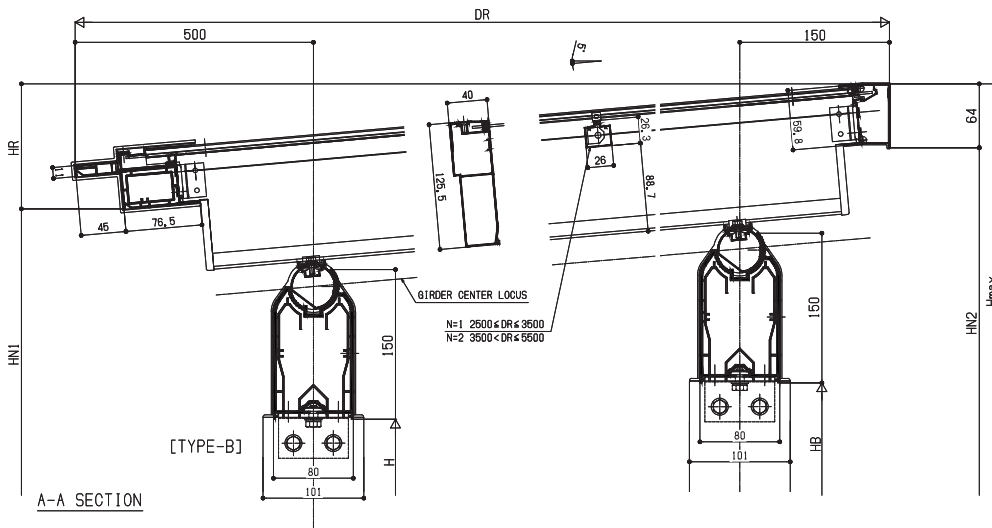

PRICE LIST

Wall Mounted SQUARE

Juta Rp

WR (mm) D R (mm)	2,500	2501- 3,000	3001- 3,500	3501- 4,000	4001- 4,500	4501- 5,000	5001- 5,500	5501- 6,000
2,500	11.2	13.2	15.1	16.3	18.2	20.2	23.1	25.2
2,501 ~ 3,000	12.2	14.4	16.5	17.8	20.0	22.2	25.4	27.8
3,001 ~ 3,500	13.1	15.6	18.0	19.3	21.8	24.2	27.7	30.4
3,501 ~ 4,000	14.3	17.0	19.7	21.2	24.0	26.7	30.5	33.5
4,001 ~ 4,500	15.3	18.2	21.2	22.7	25.7	28.7	32.8	36.1
4,501 ~ 5,000	17.6	20.9	24.2	25.9	29.3	32.6	35.1	38.6
5,001 ~ 5,500	18.7	22.2	25.8	27.6	31.3	34.8	37.4	41.2

Free Standing SQUARE

Juta Rp

WR (mm) D R (mm)	2,500	2501- 3,000	3001- 3,500	3501- 4,000	4001- 4,500	4501- 5,000	5001- 5,500	5501- 6,000
2,500	17.8	20.0	22.2	23.6	25.8	28.0	32.1	34.6
2,501 ~ 3,000	18.8	21.2	23.6	25.1	27.6	30.1	34.4	37.1
3,001 ~ 3,500	19.8	22.4	25.1	26.7	29.4	32.1	36.8	39.8
3,501 ~ 4,000	21.0	24.0	26.9	28.7	31.7	34.7	39.6	42.9
4,001 ~ 4,500	22.0	25.2	28.4	30.2	33.5	36.7	42.0	45.5
4,501 ~ 5,000	24.3	27.9	31.5	33.4	37.1	40.7	44.3	48.1
5,001 ~ 5,500	25.4	29.3	33.1	35.2	39.1	43.0	46.6	50.7

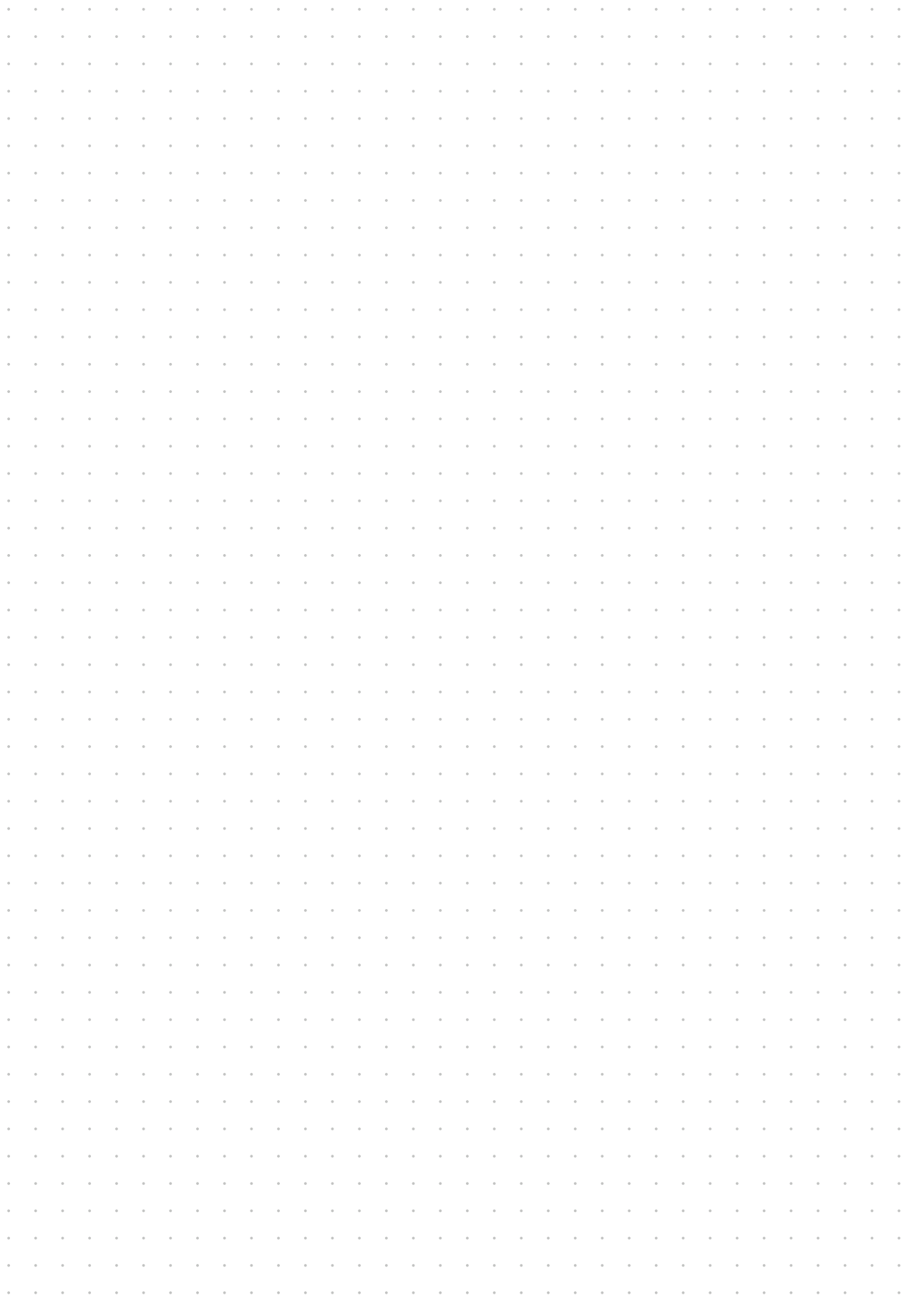

OPTIONAL PARTS

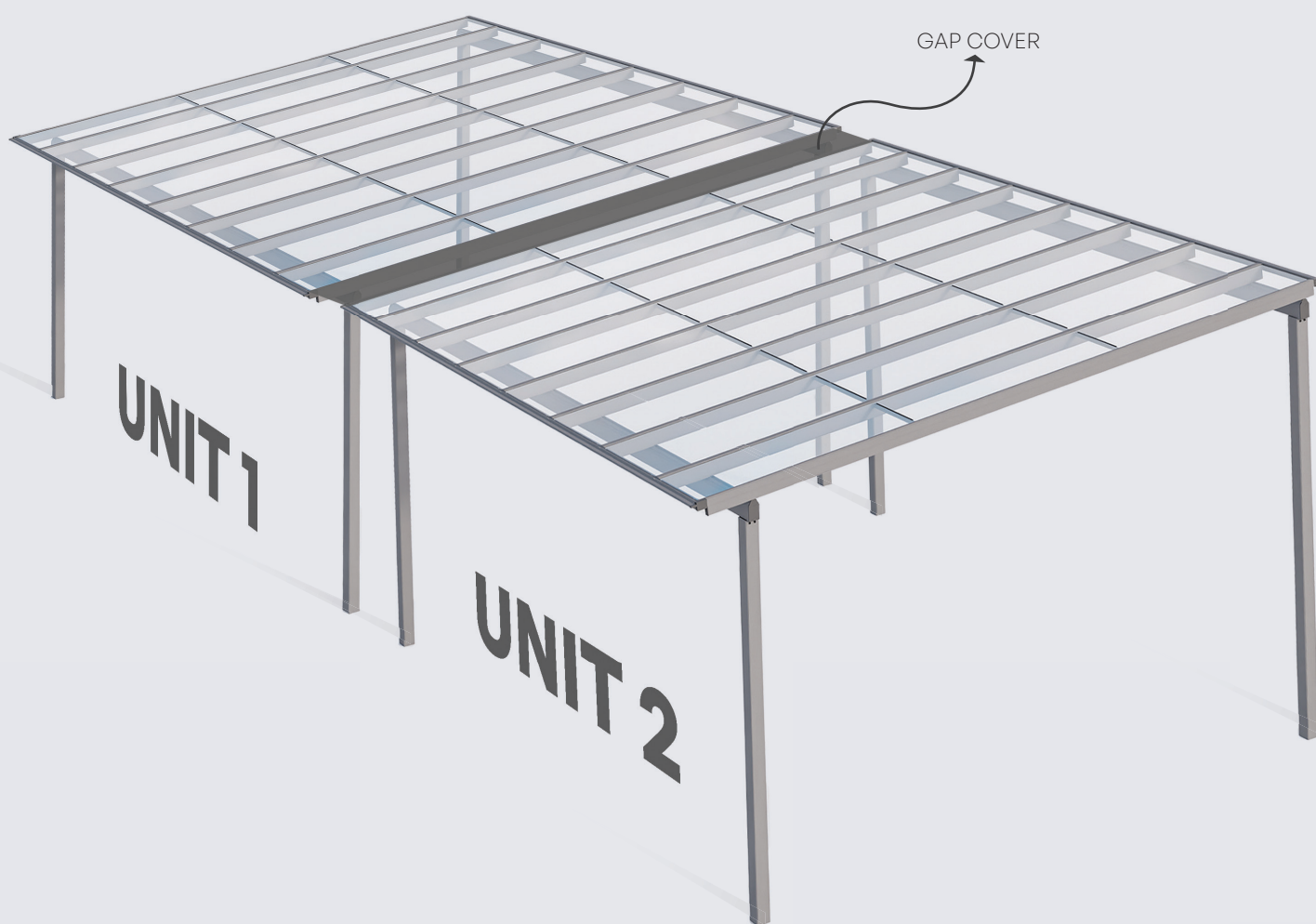

OPTIONAL PARTS

ROOF GAP COVER

In case series of building, we provide ROOF GAP COVER to avoid rain drips splash in the between.

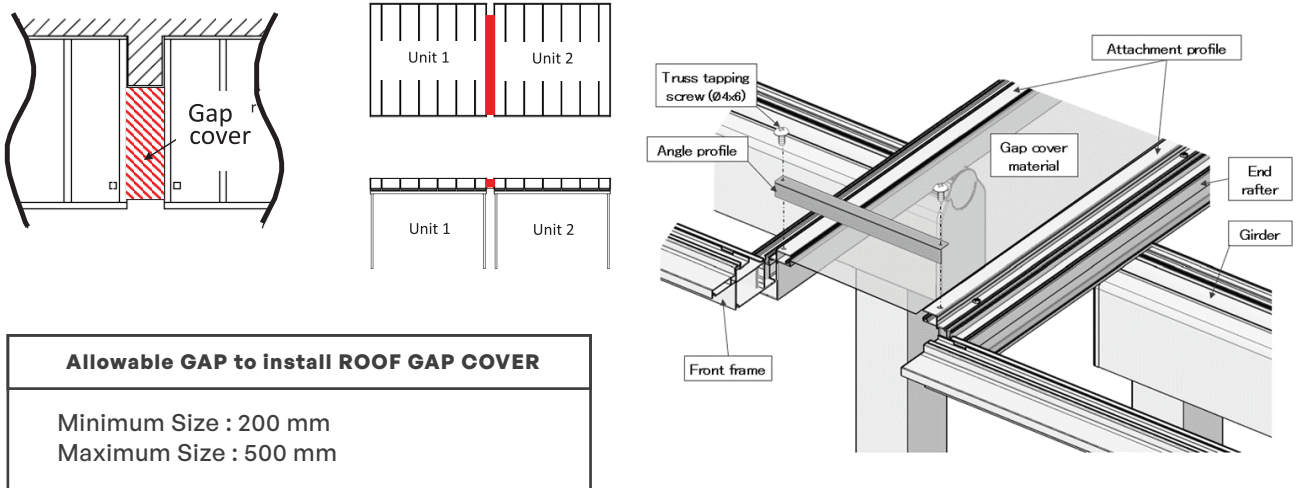

• Size Limitation

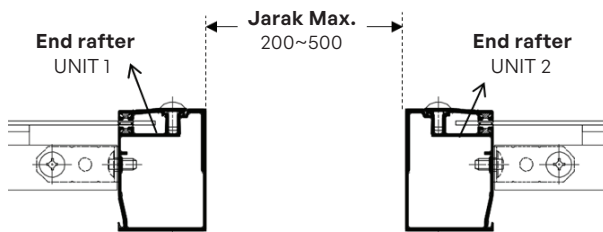

• Material Supply

YKK API	DISTRIBUTOR
1. Attachment Profile	1. GAP Cover Material
2. Angle Profile	2. Backup Material
3. Tapping Screw	3. Sealant
4. Gasket	

GIRDER EXTENSION

The construction of column position from end rafter side can be adjust with Girder Extension.

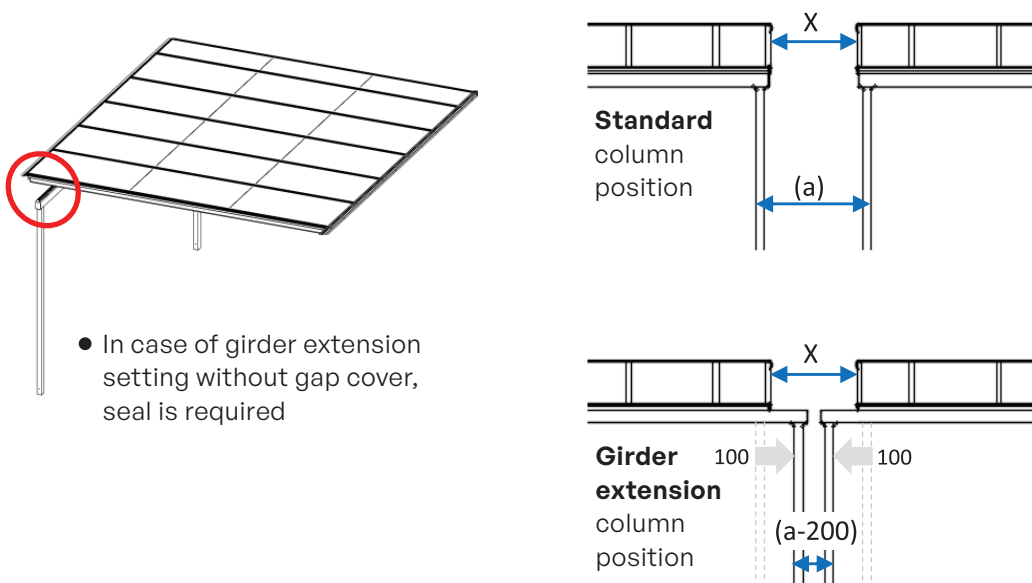

OPTIONAL PARTS

ATTACHMENT PROFILE FOR L SHAPE

Adjustable following the building shape with Attachment profile.

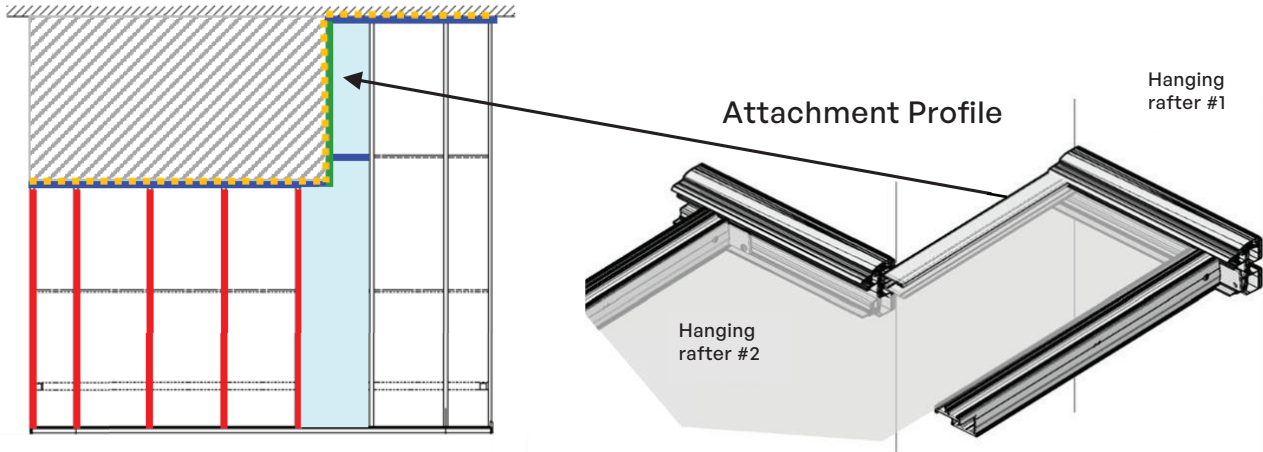

• Construction Sample



• Material Supply

Available in two sizes

YKK API	SIZE
• Attachment Profile	3000 5500

Perfect solution to cover various building shape.

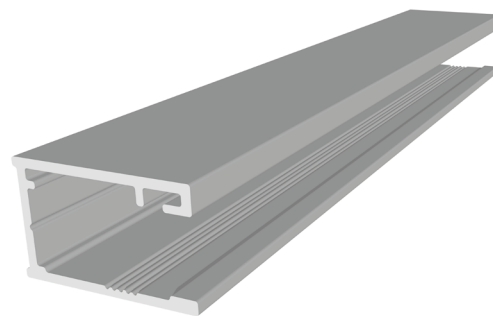
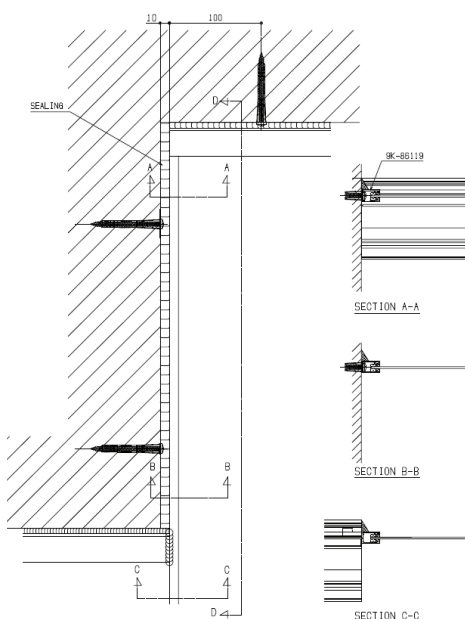

- Easy to follow Site Construction
- Simple Construction
- Same line Order with the Actual Product

| OPTIONAL PARTS

ROOF MATERIAL

Order for Roof Material are possible.

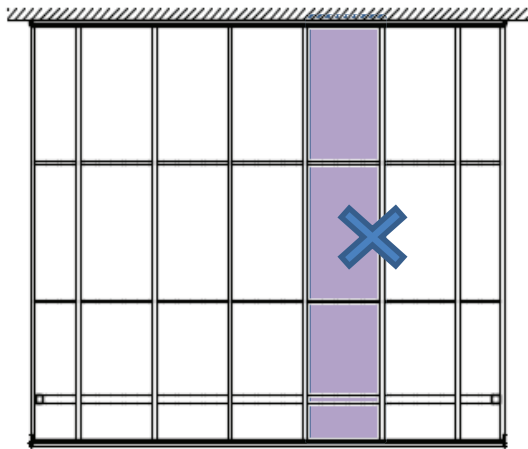

In case replacement needed,
it is easy to order and change

Available in various color as standard

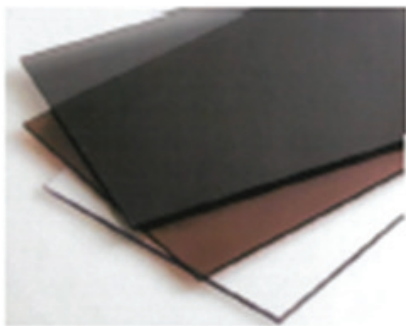

Roof Material replacement

• Material Supply

Multiple Sizes to choice base on needed

YKK API	SIZE
• Polycarbonate	404 x 2943 834 x 2943 404 x 5452 834 x 5452

OPTIONAL PARTS

BASEPLATE

Baseplate approach offers flexibility and ease of GRANROOF installation.

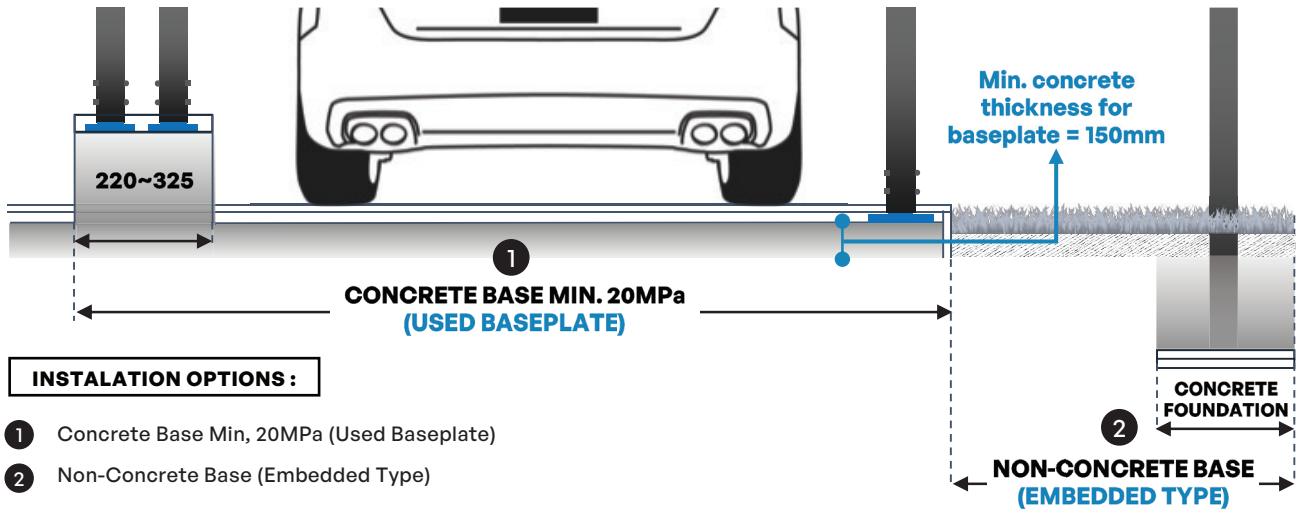

INSTALLATION OPTIONS :

- 1 Concrete Base Min, 20MPa (Used Baseplate)
- 2 Non-Concrete Base (Embedded Type)

Available Options

Free Standing Type

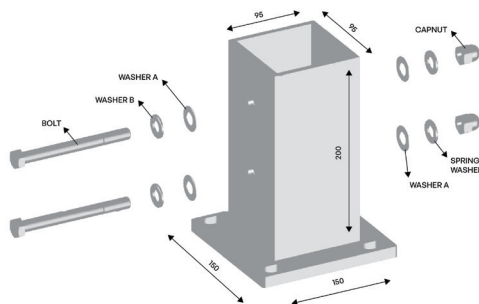

Wall Mounted Type

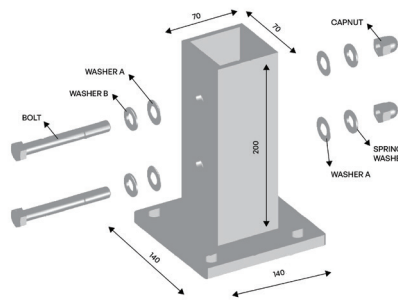

Available Color :
YK (Black)

Product Guarantee

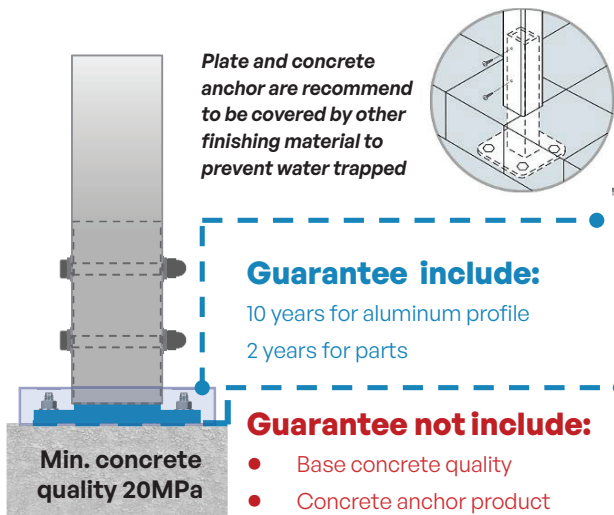

Concrete & anchor recommendation

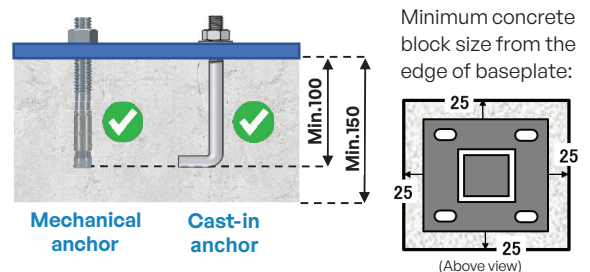

<<CAUTION>>

Do not use non-structural material such as **red or light brick** as baseplate's base



PRICE LIST

Optional Parts GAP COVER

Ribu Rp

WX(mm) DX(mm)	300	500
3,000	312.4	319.0
5,500	530.2	536.8

Optional Parts L-SHAPE

Ribu Rp

Length (mm)	Price
3,000	103.4
5,500	176.0

Roof Material Polycarbonate

Ribu Rp

W (mm) D (mm)	404	834
2,943	732.6	1,509.2
5,452	1,355.2	2,796.2

Structure Baseplate

Ribu Rp

Type	H (mm) W (mm)	200
Wall Mounted	140 x 140	770.0
Free Standing	150 x 150	925.0

*the price list above is for 1 set (including parts) for detail please check **baseplate variation options** page .

Maintenance Methods

Aluminium Products' Maintenance

Washing the product with water once or twice a year will greatly extend its life.

There are various causes of corrosion on aluminum and painted products, but the best way to protect aluminum and painted products from corrosion and maintain their beauty for a long time is to remove dirt from the surface as soon as possible. It's easy to clean dirt while it's still light, and since it's not just everyday dirt, all you need to do is wipe it lightly. Furthermore, you can greatly extend the life of aluminum and painted products by washing them regularly once or twice a year.

Cleaning Method

1. Wash off dust, dirt, etc. with water.

Aluminum (extruded shape material) has "stripe lines" depending on the direction of extrusion. Cleaning is most effective if you follow the direction of it.



2. Remove surface dirt and wash thoroughly with a soft sponge.

*Please do not use a metal scrubbing brush as this may scratch the surface

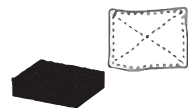

3. For dirt that cannot be removed by washing with water, gently wash with a neutral detergent (1-2% aqueous solution).



4. Finally, wipe off any moisture with a dry cloth.

After using water-soluble detergent, rinse thoroughly with water and wipe off moisture with a dry cloth

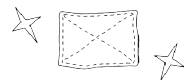

About Cleaning Agents

Acidic or alkaline cleaning agents may cause corrosion or discoloration, so please use a neutral detergent.

*Do not use chlorine-based chemicals (bleach, mold remover, etc.).

About Light Color Profile Products

For white profile products, dampen a soft cloth or tissue with liquid cleanser and water, then wipe gently and evenly until all dirt is removed.

*When using a commercially available detergent, please be careful of its properties.

Plastic Sheets' Maintenance

- Remove any adhering dirt with running water or a soft cloth dampened with water.
- Wipe off dirt with a sponge or soft cloth dampened with neutral detergent (1-2% water solvent), and then wipe thoroughly with a soft cloth dampened with water.
- Never use glass cleaners containing organic solvents. Cracks may occur.

Usage Precautions

- Please do not do the following as this may lead to unexpected accidents such as product damage or falling.
 - Putting thins on the roof
 - Climb or hang from the roof pillar
 - Lean a ladder against the roof.
- Do not use it as an evacuation or standby area during an earthquake. this may lead to an expected



PT YKK AP INDONESIA

Head Office & Factory

Kawasan Industri Manis
Jl. Manis Raya No.23, Ds. Kadu, Kec. Curug
Tangerang 15810, Banten, Indonesia
Tel: +62 21 591 9073
Fax: +62 21 591 9074
www.ykkap.co.id

Jakarta Sales & Marketing Office

Summitmas I Building
Jl. Jend. Sudirman Kav.61-62, 3rd Floor Jakarta
12190, Indonesia
Tel: +62 21 252 0745

Surabaya Branch Office

JAPFA INDOLAND CENTER
JAPFA TOWER I 6th Floor No.606-607
Jl. Jend. Basuki Rachmat 129-137 Surabaya 60271,
Jawa Timur, Indonesia
Tel: +62 31 535 1800 (Hunting)
Fax: +62 31 535 1700

YKK AP Vietnam Company Limited

Lot 5.2, 5th Leman Luxury Tower
117 Nguyen Dinh Chieu Street
Vo Thi Sau ward, District 3
Ho Chi Minh City, Vietnam
Tel: +84 8 3822 8900

YKK AP (THAILAND) CO., LTD.

Wave Place Building, 13th Floor No. 55
Wireless Road, Lumpini, Pathumwan
Bangkok 10330, Thailand
Tel: +66 2 655 6334
Fax: +66 2 655 6399



www.ykkap.co.id



 [ykkapi_official](https://www.instagram.com/ykkapi_official)



ISSUE DATE APR, 2025
PRINTED IN INDONESIA

C013-25JI-E-4